

THIS DRAWING IS THE PROPERTY OF M.N. CONSULTANTS ONE DESIGN SOLUTIONS AND IS MERELY LENT FOR LIMITED USE SUBJECT TO THE CONDITION THAT IT SHALL NOT BE REPRODUCED, LENT OR USED IN ANY WAY DETRIMENTAL TO OUR INTEREST.

SECTION DD  
SCALE: 1:100

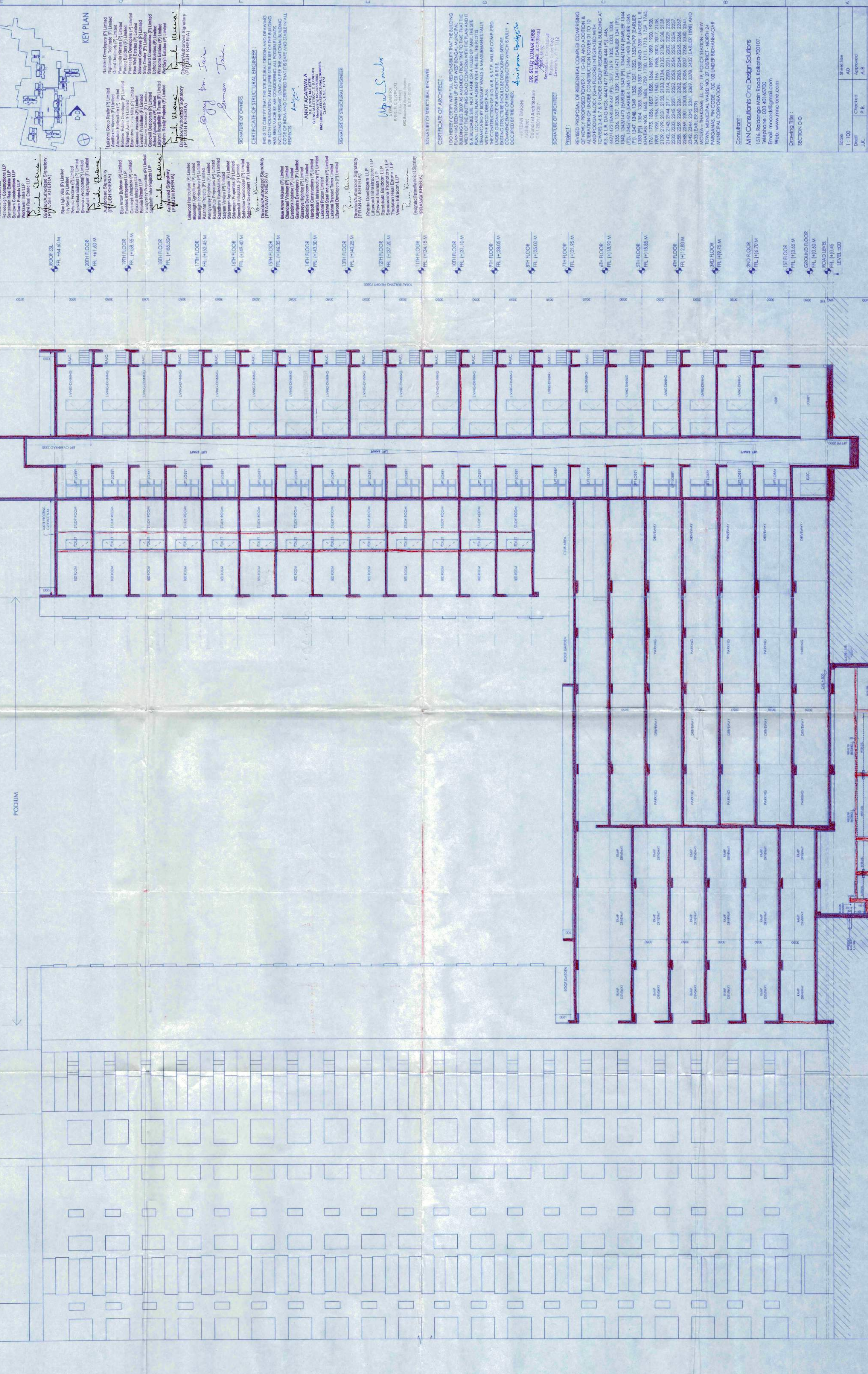

NOTES:  
1. ALL DIMENSIONS & LEVELS ARE IN MM UNLESS MENTIONED OTHERWISE.  
2. ALL EXTERNAL WALLS ARE 200 MM THICK & INTERNAL WALLS 100 MM / 150 MM THICK UNLESS OTHERWISE SPECIFIED.  
3. THE DRAWING SHALL BE READ AS CALLED FROM THE PLAN OR IN FULL.  
4. THE DRAWING SHALL BE USED FOR THE PROPOSED WORK AND SHALL NOT BE USED FOR ANY OTHER PURPOSE WITHOUT WRITTEN CONSENT FROM THE ARCHITECT.



**REGISTERED ARCHITECTS**  
M.N. CONSULTANTS ONE DESIGN SOLUTIONS  
1516, Redwood Main Road, Kharapur, 700107.  
Telephone: 033 40165700  
Email: mncood@gmail.com  
Web: www.mnc-one.com

**REGISTERED STRUCTURAL ENGINEERS**  
THE B. TO CERTIFY THAT THE STRUCTURAL DESIGN AND DRAWINGS OF BOTH FOUNDATION AND SUPERSTRUCTURE OF THE BUILDING HAS BEEN MADE BY ME CONSIDERING ALL POSSIBLE LOADS AND CONDITIONS AND THAT THE DESIGN IS IN ACCORDANCE WITH THE CODE OF PRACTICE AND CERTIFIED THAT IT IS SAFE AND STABLE IN ALL RESPECTS.  
ANIL K. SINGH  
REG. NO. 1516/2017  
CLASS: B.E.S.E. 1712

**REGISTERED CIVIL ENGINEER**  
DR. SUJEET KUMAR JOSHI  
REG. NO. 1516/2017  
CLASS: B.E.S.E. 1712

**REGISTERED ARCHITECTS**  
M.N. CONSULTANTS ONE DESIGN SOLUTIONS  
1516, Redwood Main Road, Kharapur, 700107.  
Telephone: 033 40165700  
Email: mncood@gmail.com  
Web: www.mnc-one.com

**REGISTERED STRUCTURAL ENGINEERS**  
THE B. TO CERTIFY THAT THE STRUCTURAL DESIGN AND DRAWINGS OF BOTH FOUNDATION AND SUPERSTRUCTURE OF THE BUILDING HAS BEEN MADE BY ME CONSIDERING ALL POSSIBLE LOADS AND CONDITIONS AND THAT THE DESIGN IS IN ACCORDANCE WITH THE CODE OF PRACTICE AND CERTIFIED THAT IT IS SAFE AND STABLE IN ALL RESPECTS.  
ANIL K. SINGH  
REG. NO. 1516/2017  
CLASS: B.E.S.E. 1712

**REGISTERED CIVIL ENGINEER**  
DR. SUJEET KUMAR JOSHI  
REG. NO. 1516/2017  
CLASS: B.E.S.E. 1712

Lighting Arrester  
FL: 172.82M  
L.O.P.  
FL: 170.30 M  
ROOF SLL  
FL: 164.60 M  
20TH FLOOR  
FL: 161.80 M  
19TH FLOOR  
FL: 158.85 M  
18TH FLOOR  
FL: 155.90 M  
17TH FLOOR  
FL: 152.95 M  
16TH FLOOR  
FL: 149.95 M  
15TH FLOOR  
FL: 146.95 M  
14TH FLOOR  
FL: 143.95 M  
13TH FLOOR  
FL: 140.95 M  
12TH FLOOR  
FL: 137.95 M  
11TH FLOOR  
FL: 134.95 M  
10TH FLOOR  
FL: 131.95 M  
9TH FLOOR  
FL: 128.95 M  
8TH FLOOR  
FL: 125.95 M  
7TH FLOOR  
FL: 122.95 M  
6TH FLOOR  
FL: 119.95 M  
5TH FLOOR  
FL: 116.95 M  
4TH FLOOR  
FL: 113.95 M  
3RD FLOOR  
FL: 110.95 M  
2ND FLOOR  
FL: 107.95 M  
1ST FLOOR  
FL: 104.95 M  
GROUND FLOOR  
FL: 102.00 M  
ROAD LEVEL  
FL: 101.45 LEVEL (50)

Scale: 1:100  
Checked: P.B.  
Approved: A.S.  
Contract Documents:  Contract Documents  Construction Drawings  Bill of Materials  
Drawing No: TKD-SD-25  
Date: 2016-2017/26/TKD



